



Estate Agents



Auctioneers



# **Peeks Mews, Riverside Lane, Tuckton, Bournemouth, BH6 3LD**

## **Guide Price £425,000-£450,000 Freehold**

**Two Bedroom Mews-Style Bungalow for the over 60's**  
**Entrance Hallway | Reception Room | Sun Room | Kitchen/Breakfast Room | Two Bedrooms**  
**Shower Room/WC | Additional WC | Rear Gardens | Allocated Parking | No Chain**

A rare opportunity to purchase a well presented two bedroom mews-style bungalow situated in a select modern development for the Over 60's, tucked away in a quiet yet convenient location just a few yards from the shopping parade at Tuckton. This development of just 6 homes sits behind a secure gated entrance and benefits include UPVC double glazing, gas central heating, 17' reception room - with additional sun room, two double bedrooms, modern shower room, modern kitchen/breakfast room, allocated parking space and a deceptively large garden. Viewing is highly recommended.

Enter into the hallway which has a large storage cupboard for coats, an airing cupboard and a guest w/c. The spacious lounge has sliding patio doors leading to a sun room which in turn leads out to the garden. The kitchen/breakfast room is fitted with a good range of modern wall and base units incorporating a built-in oven and hob, there is space for other appliances.

There are two double bedrooms, both have windows overlooking the garden and fitted wardrobes. The modern shower room is fitted with a shower cubicle w/c and wash basin, complimented by stylish tiling.

Outside, there is allocated parking for one car. The property enjoys surprisingly large gardens to the side and rear enjoying a secluded and sunny aspect, featuring a large patio with summerhouse and an area of artificial grass.

Tenure: Freehold  
Council Tax Band: D

Service Charge: £400 per annum contribution for the upkeep of the communal grounds.  
EPC Rating: to be confirmed









GROUND FLOOR  
732 sq.ft. (68.0 sq.m.) approx.

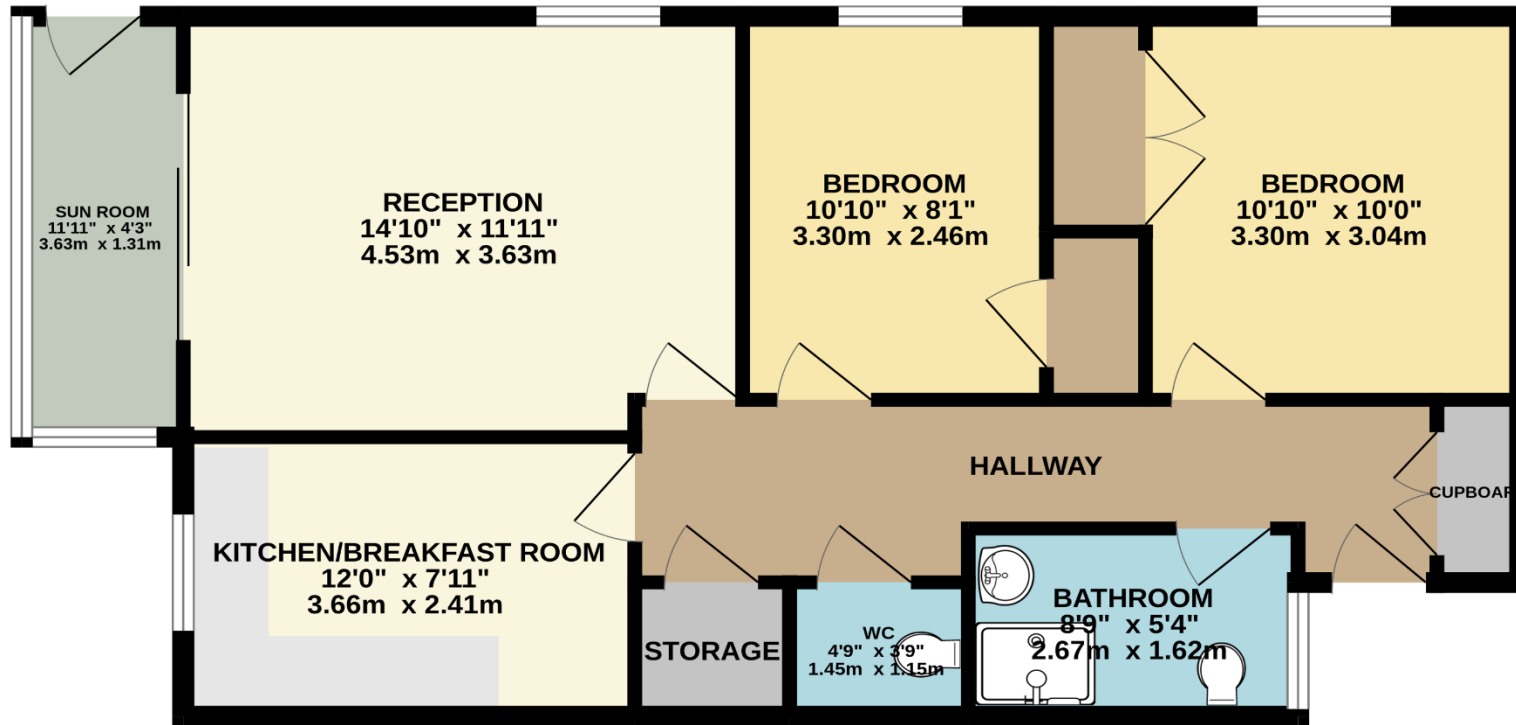

TOTAL FLOOR AREA : 732 sq.ft. (68.0 sq.m.) approx.

Whilst every attempt has been made to ensure the accuracy of the floorplan contained here, measurements of doors, windows, rooms and any other items are approximate and no responsibility is taken for any error, omission or mis-statement. This plan is for illustrative purposes only and should be used as such by any prospective purchaser. The services, systems and appliances shown have not been tested and no guarantee as to their operability or efficiency can be given.  
Made with Metropix ©2024

Disclaimer These particulars, whilst believed to be accurate are set out as a general outline only for guidance and do not constitute any part of an offer or contract. Intending purchasers should not rely on them as statements of representation of fact, but must satisfy themselves by inspection or otherwise as to their accuracy. We have not carried out a detailed survey nor tested the services, appliances and specific fittings. Room sizes should not be relied upon for carpets and furnishings. The measurements given are approximate. No person in this firm's employment has the authority to make or give any representation or warranty in respect of the property.

**Richard Godsell – Estate Agents – Auctioneers**

3 Southbourne Grove • Southbourne • Bournemouth • BH6 3RE

Tel: 01202 424214 | Email: southbourne@richardgodsell.com

Offices at

**Southbourne • Christchurch • London**

www.richardgodsell.com

